

PHILIPS

Essential SmartBright LED downlight

DN027B

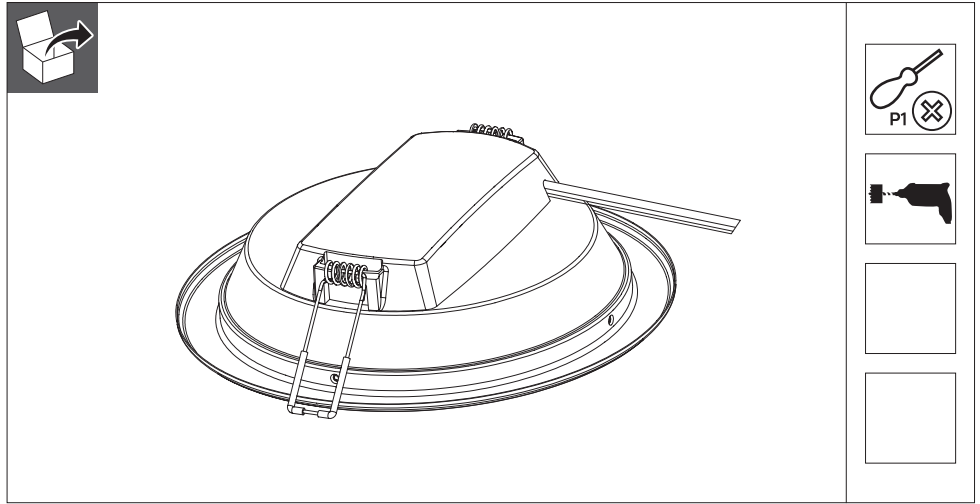

Mounting Instruction / تعليمات التركيب

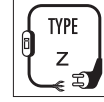
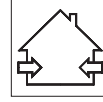
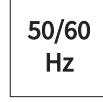
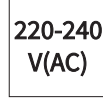
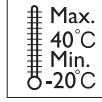
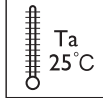
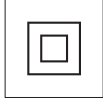

Model	Product Description	Power(W)	CRI(Ra)	CCT(K)	Total Lumen(lm)	Dimension AxB,C(mm)	Cut-Out D(mm)	Weight (kg)
9290032502	DN027B G3 LED3/WW 3W 220-240V D70 KSA	3	80	3000	300	φ95*40,36	φ70-75	0.07
9290032503	DN027B G3 LED3/NW 3W 220-240V D70 KSA	3	80	4000	330	φ95*40,36	φ70-75	0.07
9290032504	DN027B G3 LED3/CW 3W 220-240V D70 KSA	3	80	6500	330	φ95*40,36	φ70-75	0.07
9290026721	DN027B G3 LED6/WW 6W 220-240V D100 KSA	6	80	3000	600	φ125*40,36	φ100-105	0.13
9290026722	DN027B G3 LED6/NW 6W 220-240V D100 KSA	6	80	4000	600	φ125*40,36	φ100-105	0.13
9290026723	DN027B G3 LED6/CW 6W 220-240V D100 KSA	6	80	6500	600	φ125*40,36	φ100-105	0.13
9290026733	DN027B G3 LED12/WW 12W 220-240V D150 KSA	12	80	3000	1200	φ175*45,41	φ150-155	0.21
9290026734	DN027B G3 LED12/NW 12W 220-240V D150 KSA	12	80	4000	1300	φ175*45,41	φ150-155	0.21
9290026735	DN027B G3 LED12/CW 12W 220-240V D150 KSA	12	80	6500	1300	φ175*45,41	φ150-155	0.21
9290026745	DN027B G3 LED20/WW 19W 220-240V D200 KSA	19	80	3000	2000	φ225*45,41	φ200-205	0.37
9290026746	DN027B G3 LED20/NW 19W 220-240V D200 KSA	19	80	4000	2100	φ225*45,41	φ200-205	0.37
9290026747	DN027B G3 LED20/CW 19W 220-240V D200 KSA	19	80	6500	2100	φ225*45,41	φ200-205	0.37

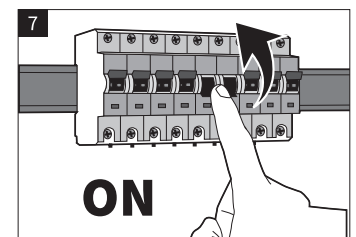
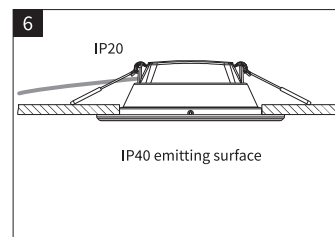
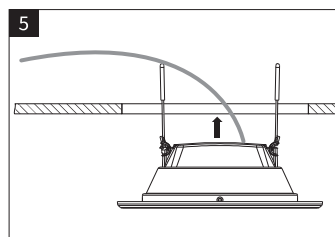
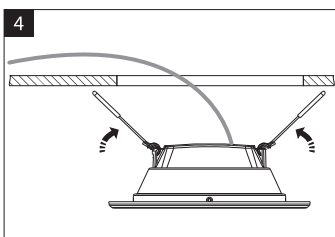
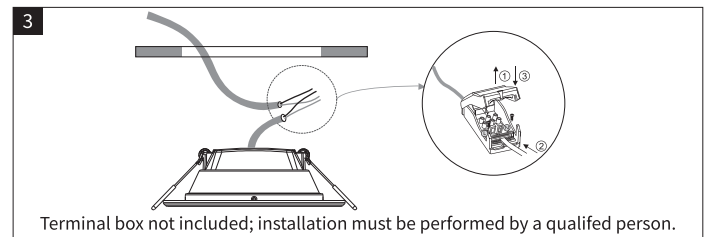
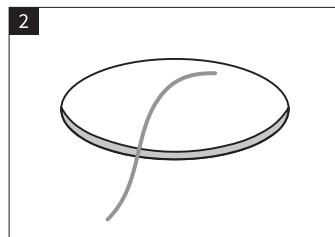
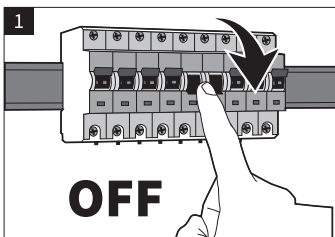
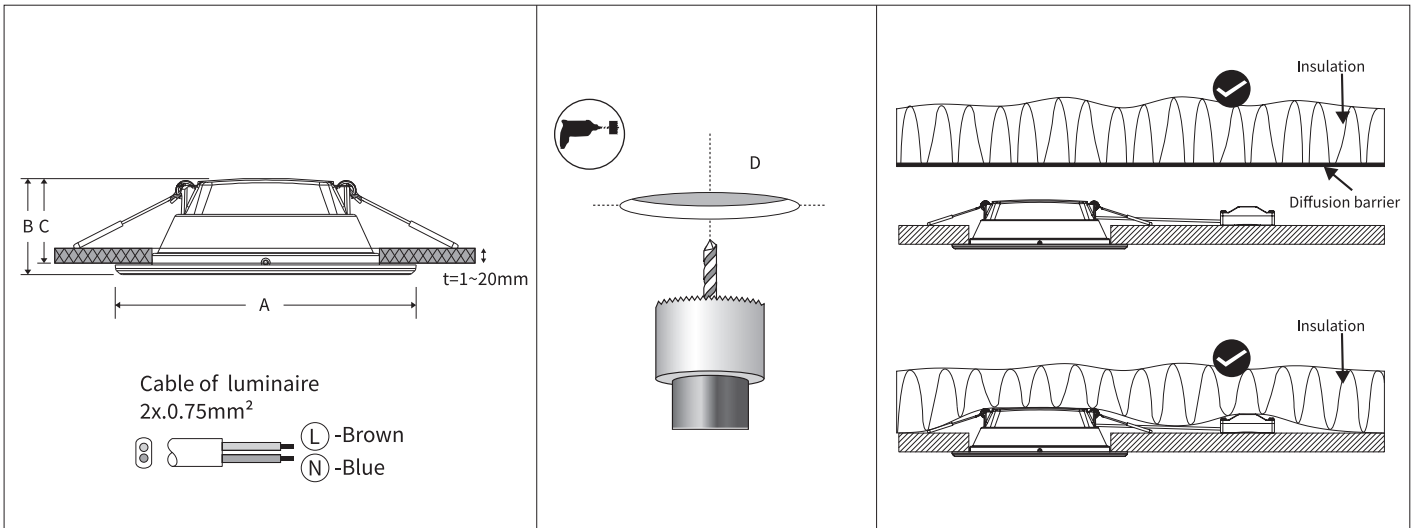

Inrush Current

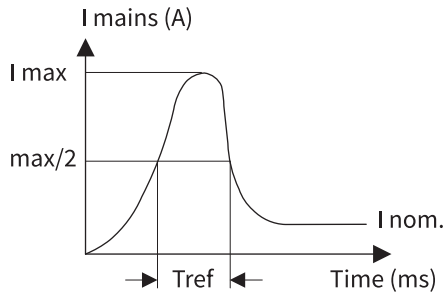

	9290032502 9290032503 9290032504	9290026721 9290026722 9290026723	9290026733 9290026734 9290026735	9290026745 9290026746 9290026747
Electrical characteristic				
I _{max} (A)	3	1.82	3.85	4.92
T _{ref} (μs)	0.1	0.114	0.101	0.115
MCB	Luminaire Max.(pcs)			
Type B-10A	135	85	46	34
Type B-16A	223	143	74	55
Type C-10A	220	145	78	59
Type C-16A	372	239	125	95



ATTENTION
OBSERVE PRECAUTIONS
FOR HANDLING
ELECTROSTATIC
SENSITIVE
DEVICES

- 01 Please read this manual before you start to install the luminaire.
- 02 The luminaire shall be installed by a qualified electrician and wired in accordance with the latest IEE electrical regulations of the national requirements.
- 03 Switch OFF the power supply before the installation or maintenance to avoid electrical shock.
- 04 The luminaire must not be used or stored in corrosive environment where hazardous materials such as Sulphur, Chlorine, Phthalates, etc., are present.

ATTENTION: Below you will find all the explanations with numeric reference to the icons respectively in front of these safety instructions:

EN

- 01- The product should only be installed indoors.
- 26- X-connection: In case of damage to the wire, it has to be replaced by a wire of the same type.
Y-connection: In case of damage to the wire, it has to be replaced only by the manufacturer, distributor or by an expert, to avoid risks.
Z-connection: The external flexible cable or cord of this luminaire cannot be replaced. If the cord is damaged, the luminaire shall be destroyed.
- 38- The product is not dimmable.
- 57- The light source of this luminaire is not replaceable; when the light source reaches its end of life the whole luminaire shall be replaced.

AR

- 01- يجب تركيب المنتج في الداخل فقط.
- 26- اتصال X: في حال تعرّض السلك للضرر، يجب استبداله بسلك من النوع عينه.
اتصال Y: في حال تعرّض السلك للضرر، يجب استبداله فقط من قِبل المصنّع أو الموزّع أو من قِبل أحد الخبراء، لتجنّب المخاطر.
اتصال Z: لا يمكن استبدال الكبل أو السلك المرن الخارجي في هذا المصباح. في حال تعرّض السلك للضرر، يجب إتلاف المصباح.
- 38- ضوء المنتج غير قابل للتخفيت.
- 57- لا يمكن استبدال مصدر الضوء لهذا المصباح؛ عندما يبلغ مصدر الضوء نهاية عمره يجب استبدال المصباح بالكامل.



3241 659 92361

© 2022 Signify Holding
©ignify

Philips and the Philips Shield Emblem are registered trademarks of Koninklijke Philips N.V. and are used under license